

## **Xeriscape Specifications:**

Xeric gardens can be full and colorful with a variety of plants. With a greater plant density, solar shading prevents the ground from drying, requiring less water.

Xeriscape planting should include a variety of mulch types to break up areas with less plant quantities. If no sod is being used, plant quantities will need to be greater than the required minimums in order to avoid large expanses of mulch material. Plants should be grouped together and not equally spaced throughout the yard. Plant groupings and different mulch types along with a mix of deciduous shrubs, evergreen shrubs, ornamental grasses, and perennials create a visual interest that enhances the individual landscape and community.

1. Present a detailed plan with sufficient detail in bed areas. The Committee will not approve plans depicted with "stripes" of mulch material with no living plant material, and large bed areas with incomplete plant lists. Care and consideration should be given to plant selections in order to achieve visual interest in all four seasons.
2. 25% of total front yard area, excluding driveways and paved walkways, to be plant bed(s).  
Example: 25% of 800 sf = 200 sf
3. Remaining front yard area to be a mixture of approved permeable materials.
4. Plant beds are required to have at minimum 1 plant per 15 sf. A variety of shrubs, perennials and grasses is encouraged. The committee reserves the right to require additional plant material be added to your xeriscape landscape plan should it be deemed necessary.  
Example: 200 sf/15 sf per plant = 14 plants
5. Remaining front yard area to have at minimum 1 plant per 30 sf. A variety of shrubs, perennials and grasses is encouraged. The committee reserves the right to require additional plant material be added to your xeriscape landscape plan should it be deemed necessary.  
Example: 600 sf/30 sf per plant = 20 plants
6. Boulders, stacked stone retaining walls and other stone applications are encouraged and permitted.
7. Trees that are in addition to community tree requirement can count towards plant count.
8. Ground Cover may consist of the following:
  - a. Rock or Stone Mulch – 1.5" minimum to cobble size, minimum 3" in depth, in blended color material. A single colored material is not approvable in large expanses.
  - b. Gravel - breeze, crushed gravel or pea gravel in blended color material. A single colored material is not approvable in large expanses.
  - c. Organic mulch of a 3" depth (wood or bark chips, pine needles, cones, sticks, straw or leaves).
  - d. Breathable (non-plastic) weed barrier under all ground cover.
  - e. Large Cobble of 3"-12" in diameter for designated drainage ways, 3:1 slopes and in water features.

COPPERLEAF COMMUNITY  
XERISCAPE EXAMPLE 1 - SMALL LOT

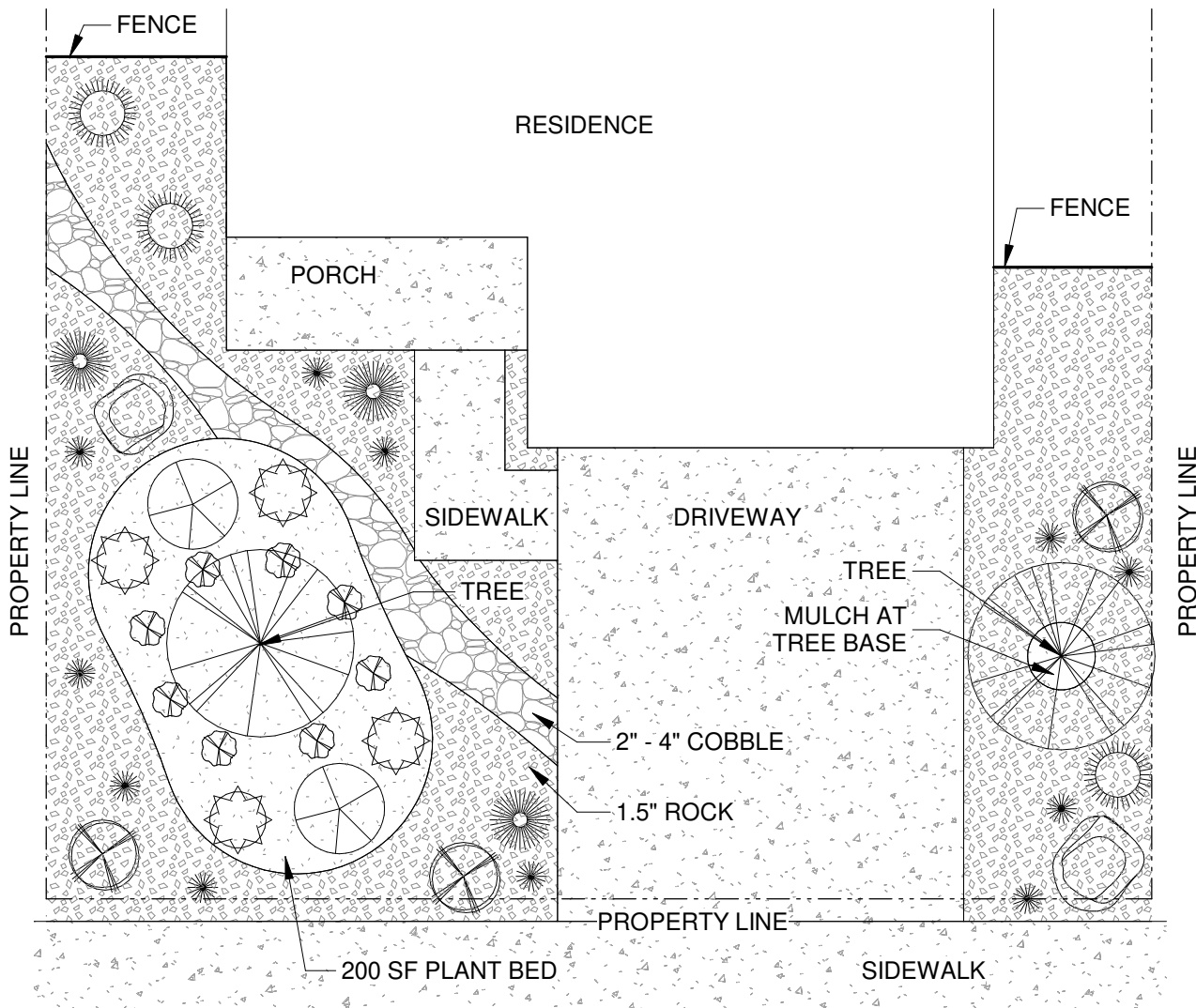

Xeriscape Example - Small Lot -  
① Approximately 800 SF Permeable Area  
1/8" = 1'-0"



COPPERLEAF COMMUNITY  
XERISCAPE EXAMPLE 2 - MEDIUM LOT

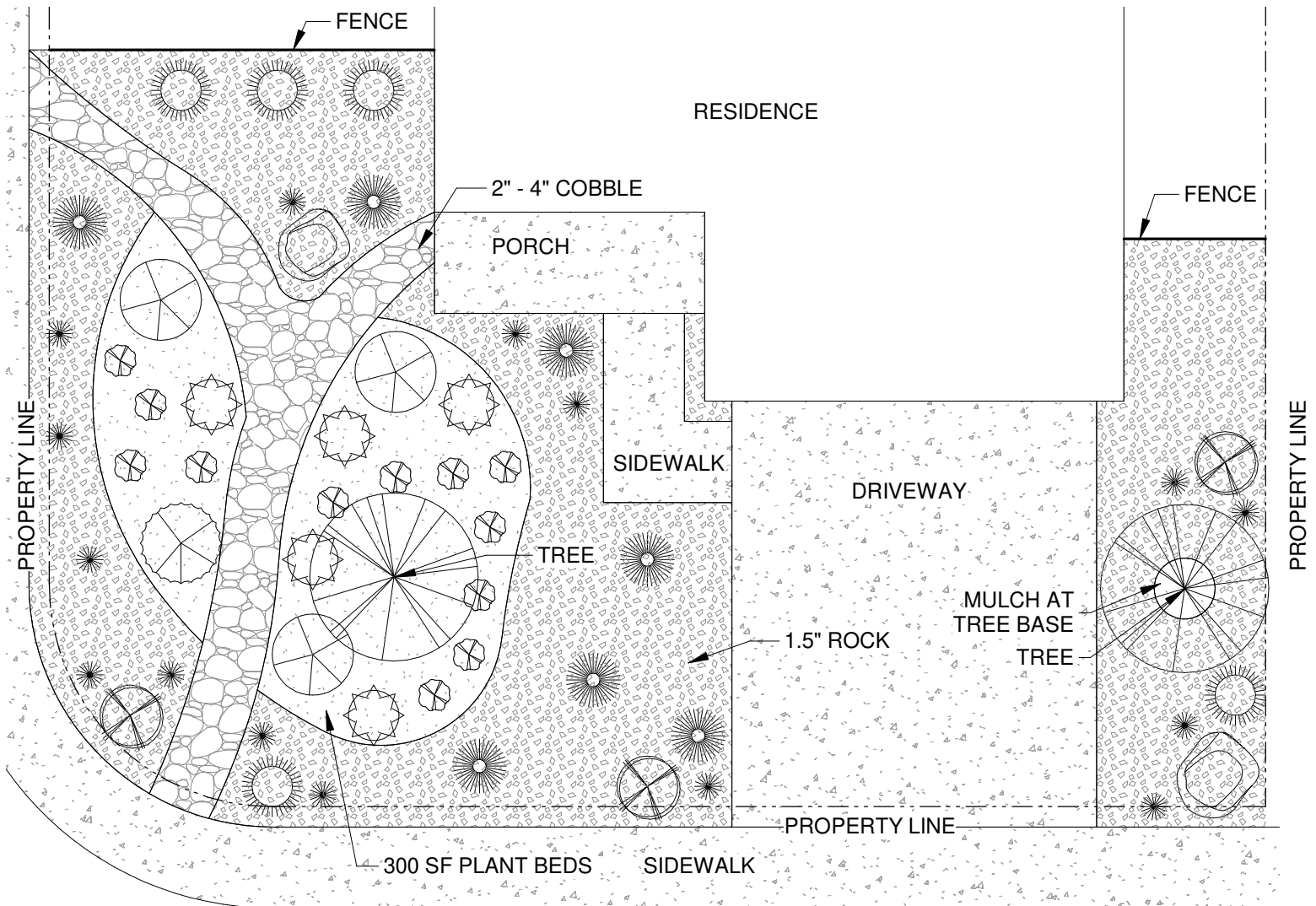

Xeriscape Example - Medium Lot -  
Approximately 1200 SF Permeable Area  
1/8" = 1'-0"

COPPERLEAF COMMUNITY  
XERISCAPE EXAMPLE 2 - LARGE LOT

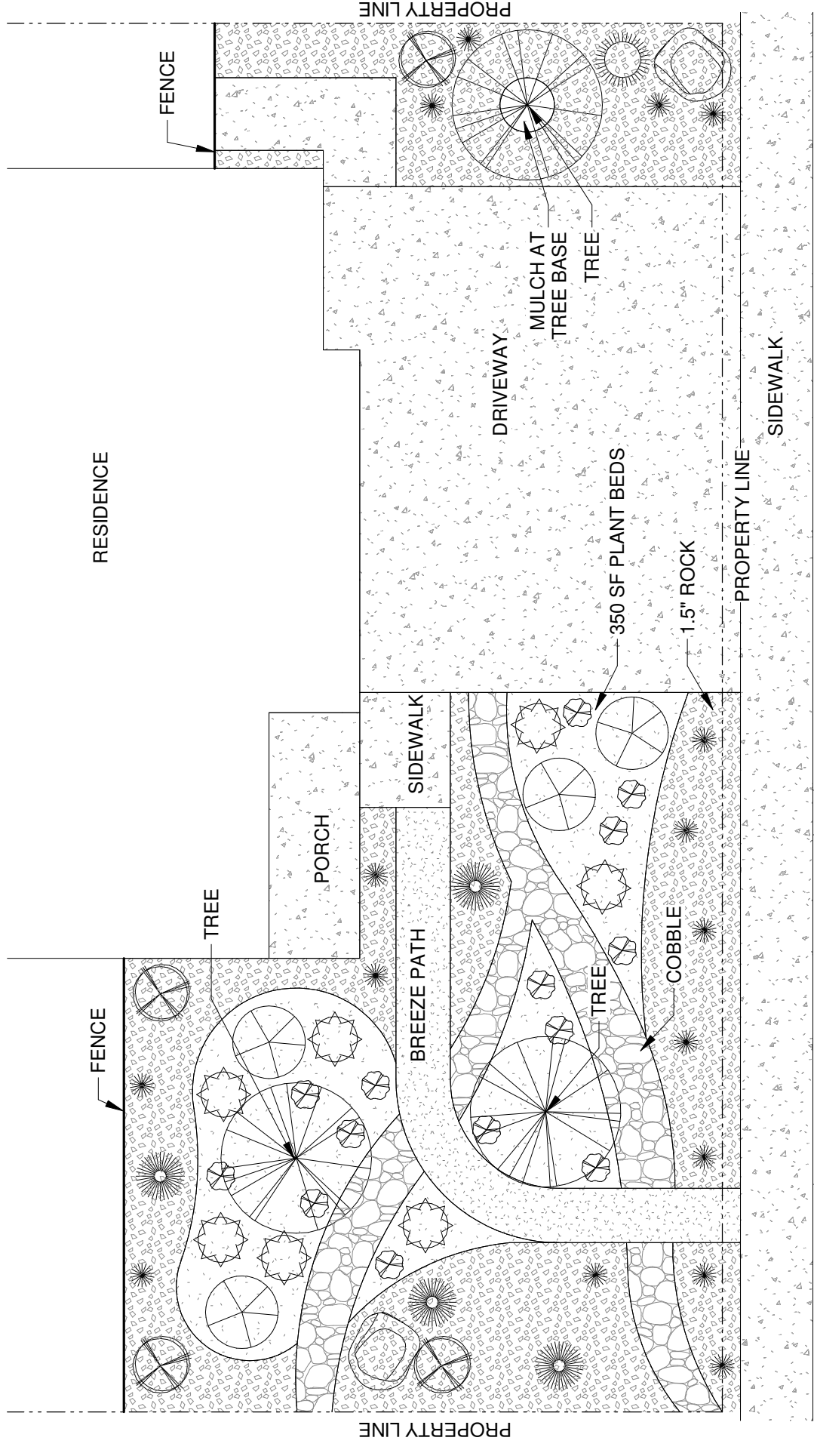
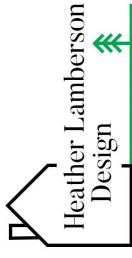

Xeriscape Example - Large Lot -  
Approximately 1400 SF Permeable Area  
1 1/8" = 1'-0"